

c|sexplovent®

*Are you sure  
your explosion  
vents will work?*

# C/S Explovent®

*The explosion vent tested to work every time.*

If you're involved with a facility where potentially explosive atmospheres, materials or processes exist, you know that it's critical for your pressure venting system to function according to its design parameters as a means of limiting damage. Many blow-out panel systems are larger or heavier than N.F.P.A. 68 recommends for maximum performance. And since these products—which typically



*Blow-out panels that rely on proper field installation may not work. But, testable, resettable Explovent is factory calibrated for release at very low pressures.*

employ shear bolts, fractionable fasteners and collapsible washers—depend solely on proper field installation, they could be extremely unreliable.

pressures. Designed to N.F.P.A. Guidelines, Explovent panels are lightweight (less than 2.5 lb./sq.ft.) in order to react quickly to pressure build up. Explovent panels are testable at any time, and unlike blow-out siding, Explovent is resettable after an event.



### Meets All Codes

In addition to meeting N.F.P.A. 68, Explovent conforms to IFC section 911 and all building codes. And Factory Mutual has granted approval of Explovent for use in damage limiting construction utilizing its two inch fiber-glass core. For complete details and a technical binder, call the C/S Specialty Venting team at 800-222-0201 or go to [www.c-sgroup.com](http://www.c-sgroup.com).



### Explovent: Testable, Resettable

FM tested and approved Explovent panels are engineered and fully calibrated at the factory for release at very low design

**It's the only field testable system.**  
With other systems you won't know until there's an explosion.



### Here's how Explovent works:

Explovent's patented release mechanism is factory calibrated for release at very low pressures, (5psf), yet keeps panels closed until an event occurs.



Normal condition

FM approved Explovent panels are lightweight to release quickly during an explosion.

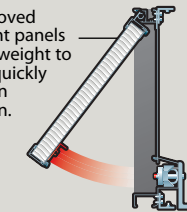

During an explosion

Once the pressure of an explosion has been relieved the panels return to a near closed position allowing air to return into the room to address implosion concerns.



After an explosion

### An Explovent for every condition

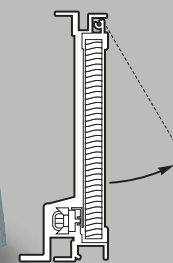

#### Insulated Aluminum Panel ERP-IC

FM approved and labeled. Designed in accordance with NFPA 68 standards and all fire codes.

Insulated and well sealed to provide a draft free environment.

Available in Kynar 500 and anodized finishes.

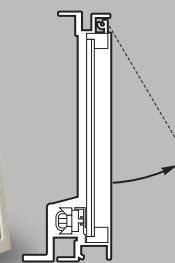

#### Translucent Polycarbonate Panel ERP-PC

Designed in accordance with NFPA 68 standards and all building and fire codes.

Translucent panels reduce need for artificial lighting.

High strength polycarbonate inserts, available in clear, white or bronze tint.

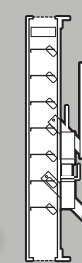

#### Explosion Relief Louver ERL

Provides explosion or pressure venting with the ability to handle every day exhaust and intake ventilation requirements.

Suitable for applications where exterior interference is present that would block the operation of standard vents.

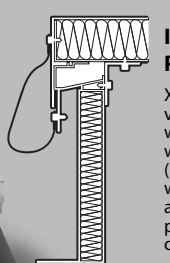

#### Insulated Aluminum Panel XRV-IC

XRV-IC roof explosion vents are for buildings where the exterior wall area is insufficient (internal rooms), or where exterior walls are obstructed, thus preventing the use of wall vents.

The XRV-IC insulated aluminum cover offers enhanced thermal performance.

For technical information visit us online @ [www.c-sgroup.com](http://www.c-sgroup.com)



**Construction Specialties™**

49 Meeker Avenue, Cranford, New Jersey 07016 U.S.A., 800-222-0201

895 Lakefront Promenade, Mississauga, Ontario L5E 2C2 Canada, 905-274-3611

🌐 [www.c-sgroup.com](http://www.c-sgroup.com)



### **The C/S Family of Products**

For 60 years, Construction Specialties has been a leader in architectural specialty products, including: Acrovyn® Wall and Door Protection, Pedisystems® Entrance Flooring, Expansion Joint Covers, Cubicle Track and Curtains, Smoke and Explosion Venting Systems, Architectural Grilles, Architectural Louvers and Sun Controls.

We have operations throughout the world and can provide C/S Products virtually anywhere. For a complete list of our international locations, visit [www.c-sgroup.com](http://www.c-sgroup.com).

*For the nearest C/S representative, or literature and samples, call toll free 800-222-0201 in U.S.A. and 888-895-8955 in Canada, or visit [www.c-sgroup.com](http://www.c-sgroup.com)*

©Copyright 2008 Construction Specialties, Inc.

Construction Specialties, Inc. reserves the right to make design changes or to withdraw any design without notice. Printed in U.S.A. Series 09